

# Rare Apartment Land in North Rio Rancho

3 Blocks South of City Center | Rio Rancho, NM

**FOR SALE**

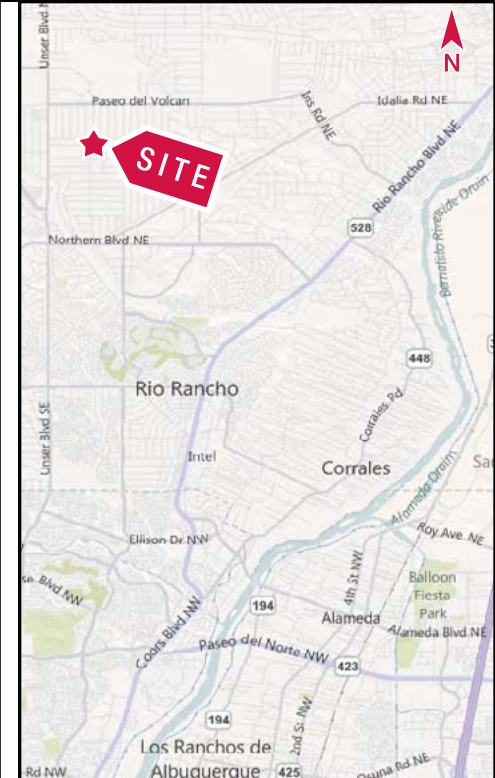

## PROPERTY DETAILS

<b>LOCATION</b>	<b>3 Blocks South of City Center Rio Rancho, NM 87124</b>
<b>SALE PRICE</b>	<b>\$1,500,000 (\$2.99/sf)</b>
<b>LAND</b>	<b>±11.5 ac (±500,940 sf)</b>
<b>ZONING</b>	<b>R-6 32 Dwelling units per acre 6-Story; 72 foot height restriction</b>

- BENEFITS**
- **Area Employers:** Hewlett-Packard, Rio Rancho City Center, UNM Westside Campus, Santa Ana Star Center and UNM Sandoval Regional Medical Center
  - **City water at site; all other utilities in local area**
  - **One of the few remaining Apartment parcels in Rio Rancho**
  - **Will subdivide**

The information contained is believed reliable. While we do not doubt the accuracy, we have not verified it and make no guarantee, warranty or representation about it. It is your responsibility to independently confirm its accuracy and completeness. Any projection, opinion, assumption or estimated uses are for example only and do not represent the current or future performance of the property. The value of this transaction to you depends on many factors which should be evaluated by your tax, financial, and legal counsel. You and your counsel should conduct a careful independent investigation of the property to determine that it is suitable to your needs.

**NAI Maestas & Ward**  
Commercial Real Estate Services, Worldwide.

For more information please contact:

**ERIK OLSON, CCIM**  
Owner/Broker  
erik@gotSPACEUSA.com  
505.463.7708

www.gotSPACEUSA.com

6801 Jefferson NE, Suite 200  
Albuquerque, NM 87109

**505.878.0001**

09.01.11

# got space

SITE PLAT

RARE APARTMENT LAND IN NORTH RIO RANCHO | RIO RANCHO, NM



For more information please contact:

**ERIK OLSON, CCIM**

Owner/Broker

erik@gotspaceusa.com

505.463.7708

www.gotspaceusa.com

6801 Jefferson NE, Suite 200

Albuquerque, NM 87109

**505.878.0001**

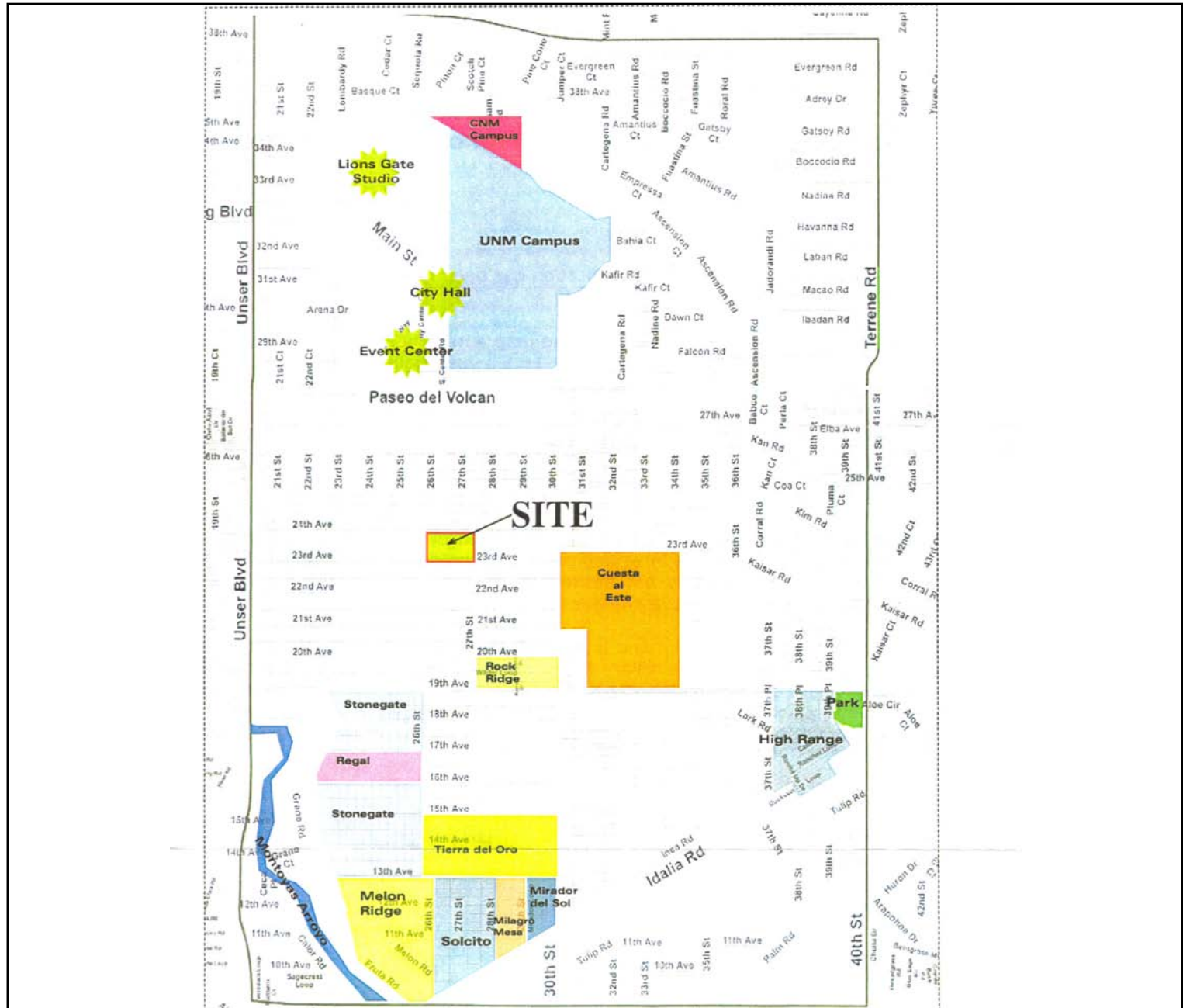

**NAI Maestas & Ward**

Commercial Real Estate Services, Worldwide.

The information contained is believed reliable. While we do not doubt the accuracy, we have not verified it and make no guarantee, warranty or representation about it. It is your responsibility to independently confirm its accuracy and completeness. Any projection, opinion, assumption or estimated uses are for example only and do not represent the current or future performance of the property. The value of this transaction to you depends on many factors which should be evaluated by your tax, financial, and legal counsel. You and your counsel should conduct a careful independent investigation of the property to determine that it is suitable to your needs.

# got space

## MULTIFAMILY TRENDS

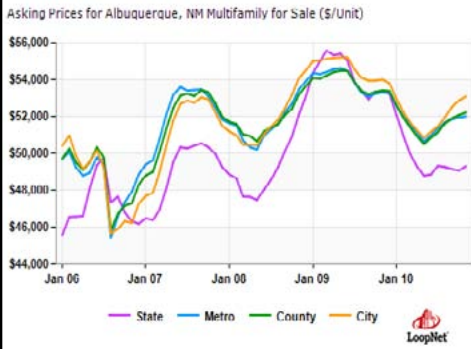

Current Albuquerque market trends data indicates an increase of +1.2% in the median asking price per unit for Multifamily properties compared to the prior 3 months, with a decrease of -1.7% compared to last year's prices. County-wide, asking prices for Multifamily properties are 0.7% higher at \$52,211 per unit compared to the current median price of \$53,076 per unit for Multifamily properties in Albuquerque, NM.

Source: [www.loopnet.com](http://www.loopnet.com)

For more information please contact:

**ERIK OLSON, CCIM**

Owner/Broker  
erik@gotspaceusa.com  
505.463.7708

[www.gotspaceusa.com](http://www.gotspaceusa.com)

6801 Jefferson NE, Suite 200  
Albuquerque, NM 87109

**505.878.0001**

## AREA PHOTOS

## RARE APARTMENT LAND IN NORTH RIO RANCHO | RIO RANCHO, NM



**NAI Maestas & Ward**  
Commercial Real Estate Services, Worldwide.

The information contained is believed reliable. While we do not doubt the accuracy, we have not verified it and make no guarantee, warranty or representation about it. It is your responsibility to independently confirm its accuracy and completeness. Any projection, opinion, assumption or estimated uses are for example only and do not represent the current or future performance of the property. The value of this transaction to you depends on many factors which should be evaluated by your tax, financial, and legal counsel. You and your counsel should conduct a careful independent investigation of the property to determine that it is suitable to your needs.